



# Jetson™

The Best Quality Office Pods at a Budget-Friendly Price | **MUTE.**

**Versatile, durable,  
affordable and  
highly functional  
acoustic pods.**



# Jetson S1



A phone booth  
for quick calls

👤 1

↕ 1000 × 1000 × 2264 mm

))) 27,2 dB class B per ISO 23351-1

🌀 Nom. airflow: 182,5 m3/h

🔧 No-tools assembly in 30 min

# Jetson M1



A comfortable acoustic  
pod for focused work

👤 1

↕ 1575 × 1000 × 2264 mm

))) ~26,5 dB class B per ISO 23351-1

🌀 Nom. airflow: 365 m3/h

🔧 No-tools assembly in 40 min

# Jetson L2



An office pod for effective  
1:1 meetings

👤 2

↕ 2150 × 1000 × 2264 mm

))) ~26,5 dB class B per ISO 23351-1

🌀 Nom. airflow: 365 m3/h

🔧 No-tools assembly in 45 min

# Jetson L4



A meeting space  
for teamwork

👤 4

↕ 2150 × 1270 × 2264 mm

))) 26,5 dB class B per ISO 23351-1

🌀 Nom. airflow: 730 m3/h

🔧 No-tools assembly in 45 min

Innovation-  
driven



People-  
focused



Cost and  
time effective



# Innovation-driven



**Fastest on the market  
no-tools wall assembly**

PATENT PENDING



**Advanced and safe  
mediaport**



**Durable and super-light  
aluminum structure**

# People-focused



Efficient and comfortable lighting



VOCs and formaldehyde free



Ergonomic design

# Assured equipment

Shelves, display rail and wall hook can be placed on every wall, at any height, for unprecedented accessibility & simplicity of reconfiguration.



**Jetson S1**  
info@witteveen.nl

**Jetson M1**  
www.telefooncel.info

# Assured equipment



Jetson L2/L4



# Ready to adjust Library set

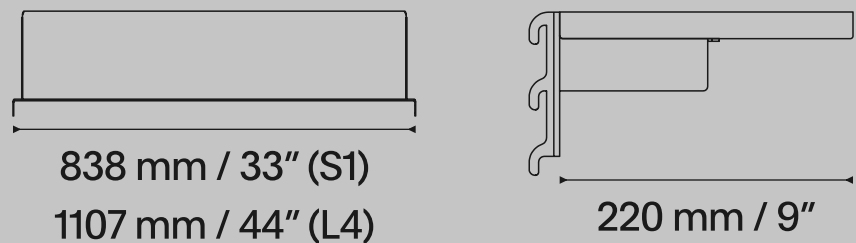
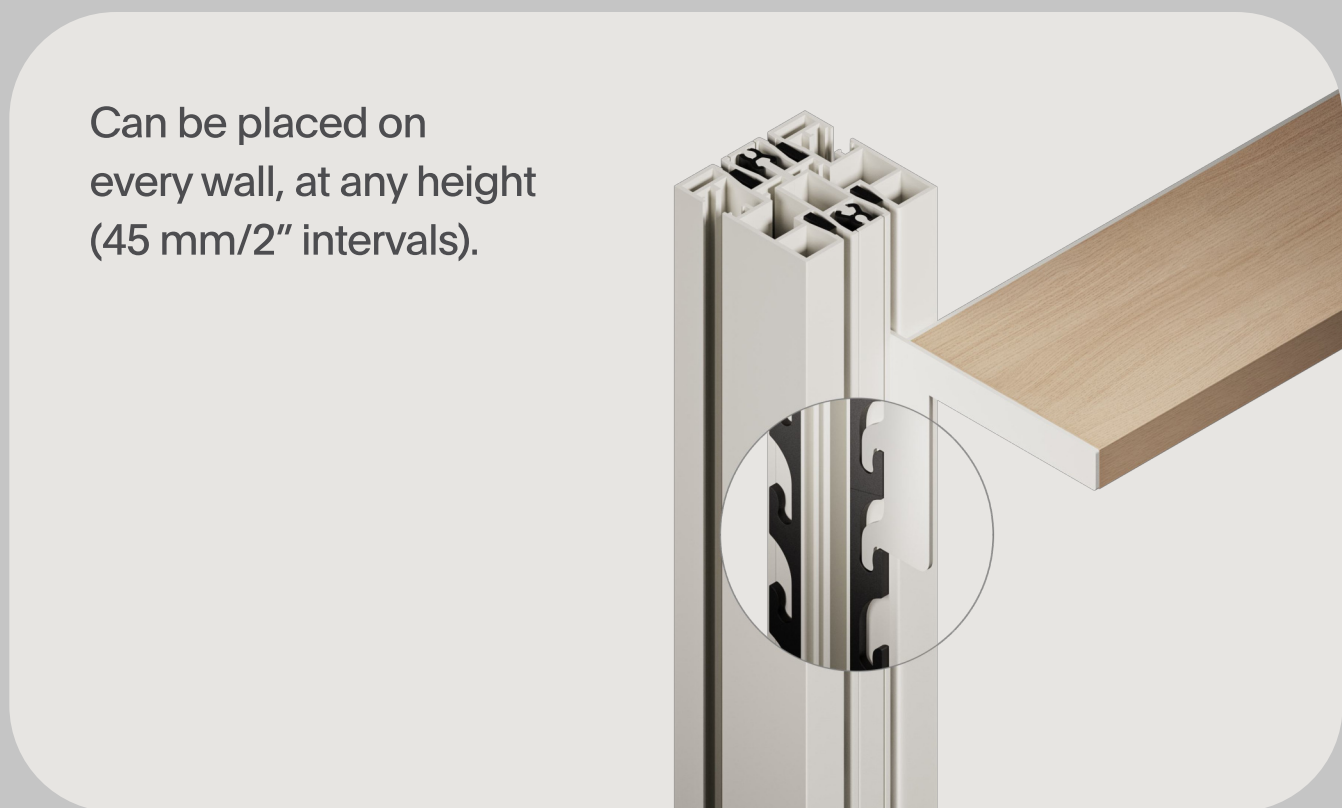

2× Magnet

1× Wall hook

1× Stand



1× Display rail



1× Shallow shelf



2× Bookend



Brackets match the pod's color.

# Ready to adjust Note set



Can be placed on every wall, at any height (45 mm/2" intervals).



# Cost and time effective

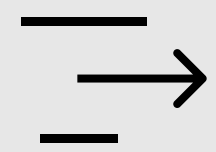

**Fast delivery  
available\***



**Ready from  
day one**



**5 year  
guaranty**



### External walls & frame



Moon White

PANTONE GREY 403051

Void Black

NCS S8500-N

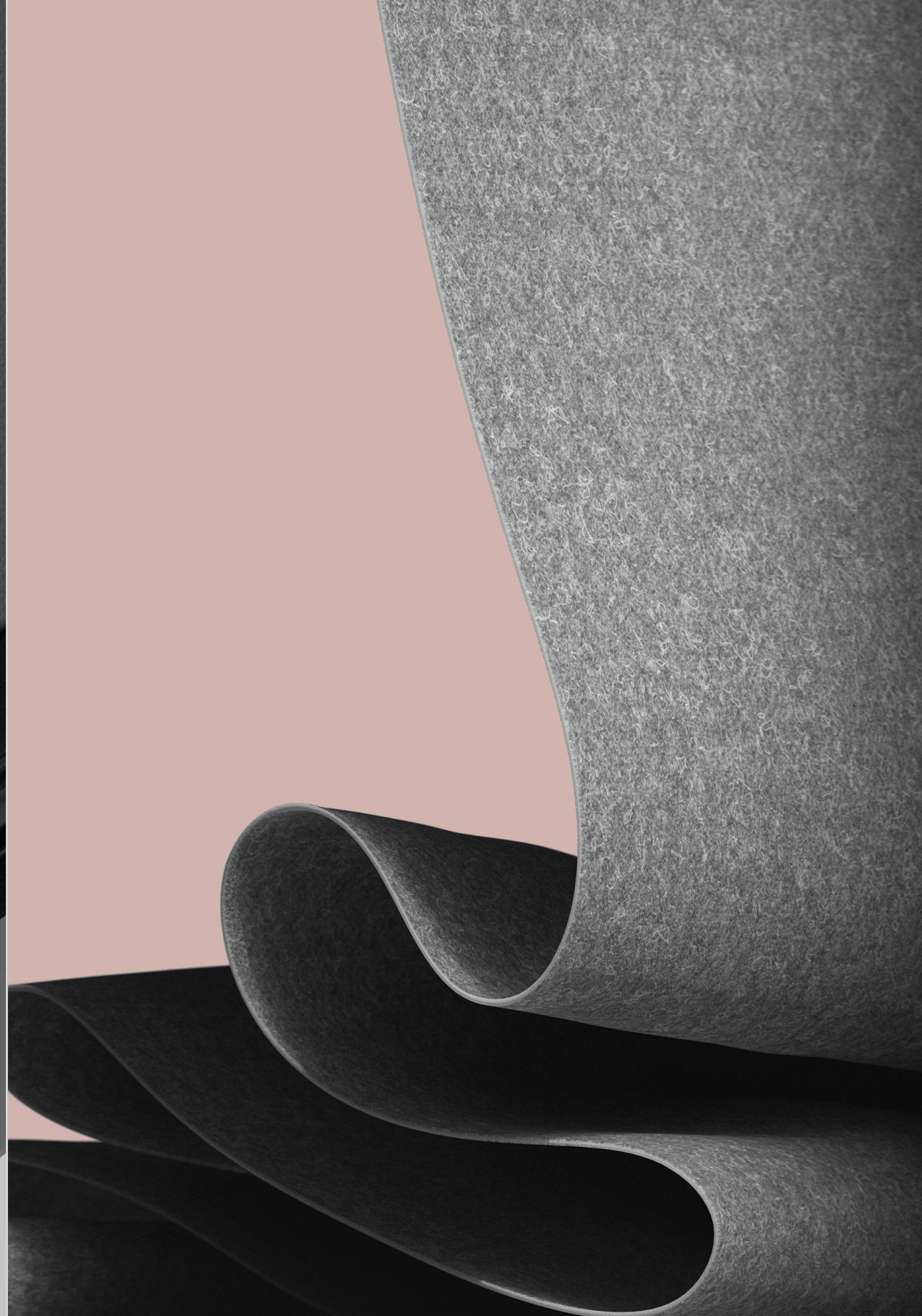

### Interior walls & ceiling



Light gray felt

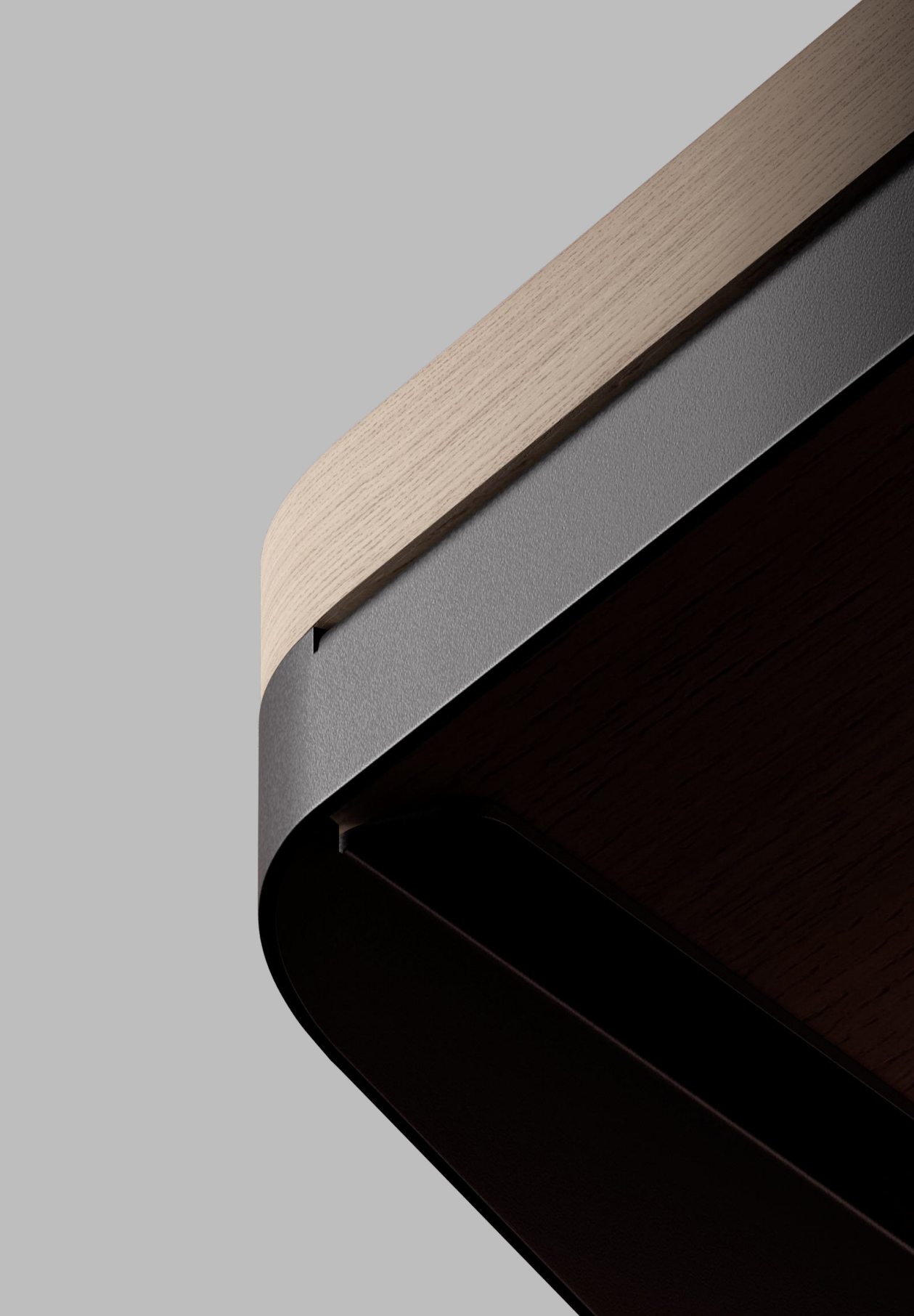

### Tabletop & shelves



Oak wood melamine



### Seating upholstery



Gabriel Chili

60115

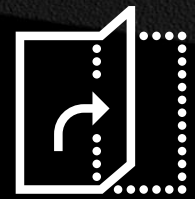

## Designed for disassembly

Our engineers implemented DfD tactics to ensure the next practical use of each Jetson's part.

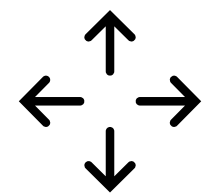

## Agile equals sustainable

Easy to adapt and move. Jetson adds flexibility to your office space and makes a perfect alternative to fixed construction.

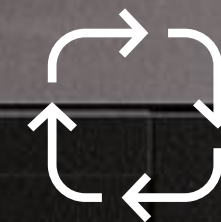

## Hero aluminum

Aluminum is 70 percent recycled material that can be reused over and over again.

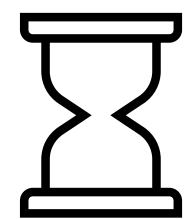

## Built to last

Extruded aluminum structure means you won't need any other pod for years and years. And the planet will appreciate it.



## Easy-repairable

Jetson is constructed entirely of easy-replaceable elements. So if needed, the repair is quick, cheap, and easy.

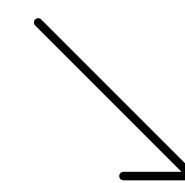

## Light on CO<sub>2</sub>

Jetson's lightweight construction reduces CO<sub>2</sub> emissions in transportation.



**Meet ISO 9001**  
Environmental management system



**Shipped in flat cardboards**  
Reducing the carbon footprint



**Meet European Union Restriction of Hazardous Substances Directive**  
2002/95/EC (RoHS 1)



**Meet ISO 14001**  
Certified Production Process



**Free from formaldehyde**  
VOC Tested



**Meet Conformité Européenne**  
Assessed and deemed to meet EU safety standards

# Configure your own setup online

Configure Jetson

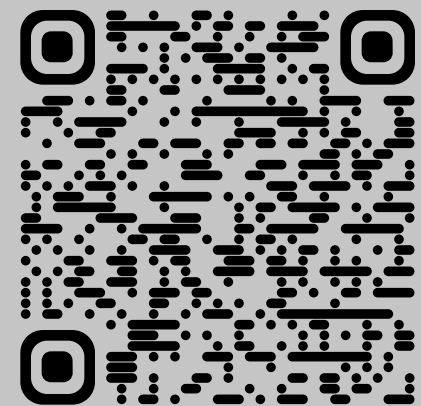

[www.mute.design/configurator](http://www.mute.design/configurator)



## Size

S1



M1



L2



L4



## Color

Void Black



Moon White



## Accessories

Stool



Library Set



Notes Set



# Flat-packed

# S1/M1/L2/L4

S1

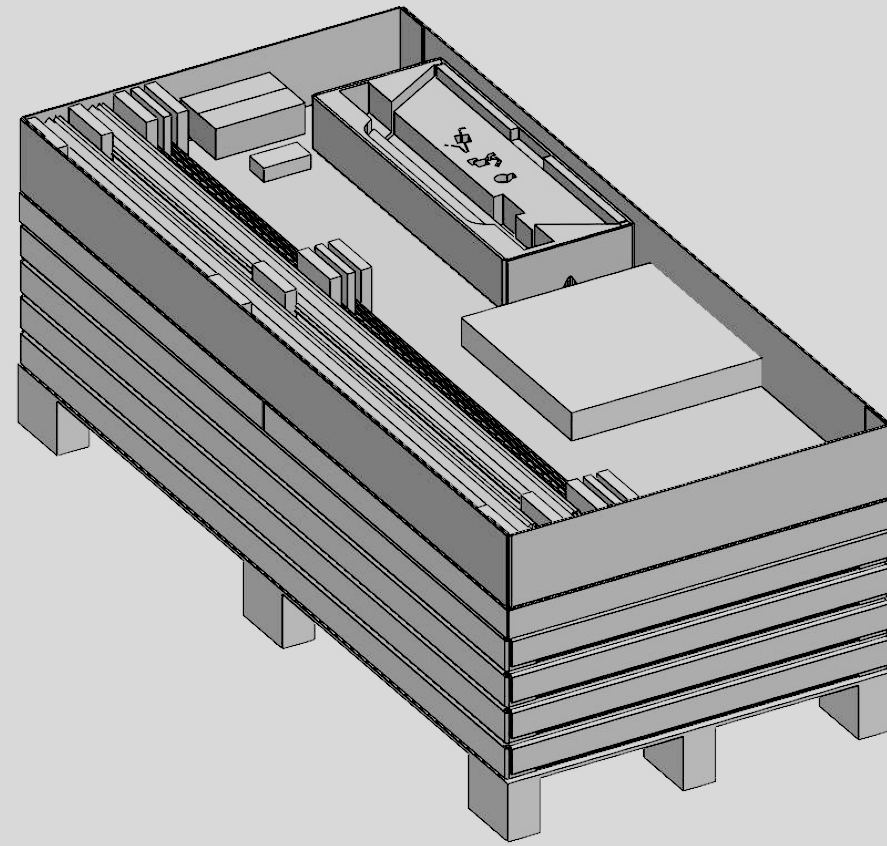

## PACKING

---

Shipment weight	250 kg
Cartboard flat-packs	6 layers
Wooden pallet	19 kg
Plywood pallet	30 kg
Dimensions	2270 x 1000 x 860 mm
Possibility of stacking	2 pods

M1

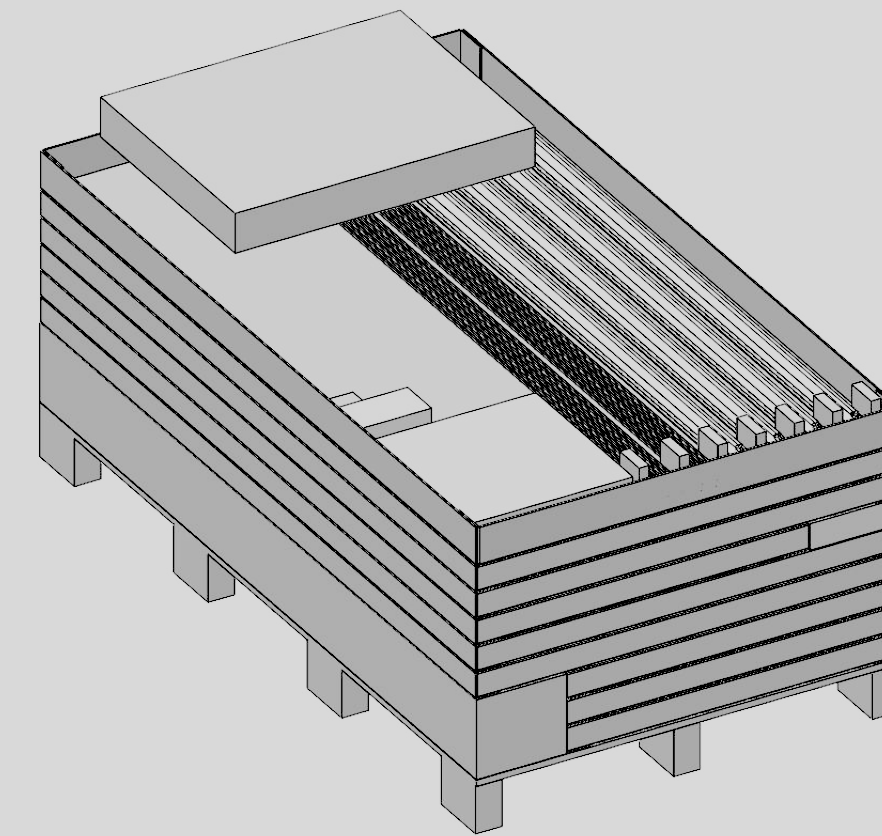

## PACKING

---

Shipment weight	320 kg
Cartboard flat-packs	9 layers
Wooden pallet	29 kg
Plywood pallet	40 kg
Dimensions	2270 x 1270 x 960 mm
Possibility of stacking	2 pods



# Flat-packed

S1/M1/L2/L4

L2

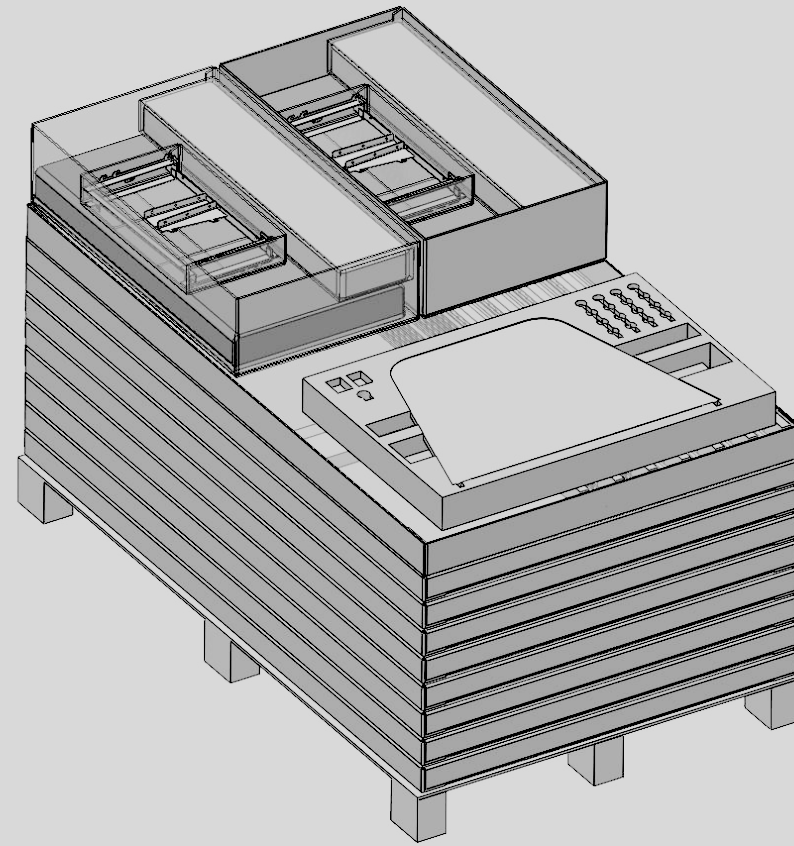

## PACKING

---

Shipment weight	430 kg
Cartboard flat-packs	10 layers
Wooden pallet	29 kg
Plywood pallet	40 kg
Dimensions	2270 x 1270 x 1200 mm
Possibility of stacking	2 pods

L4

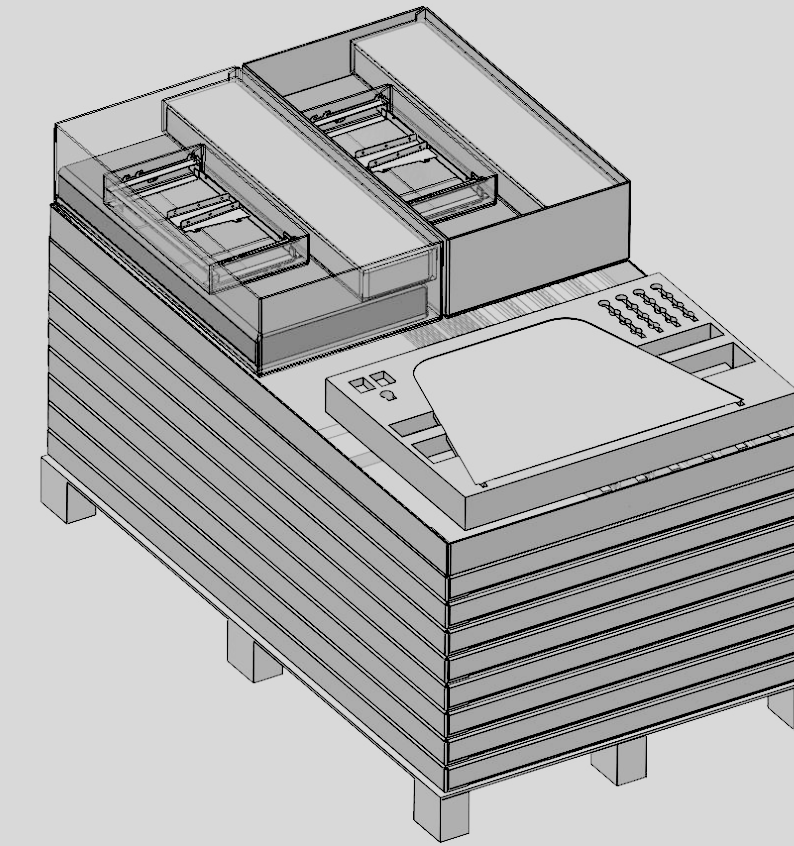

## PACKING

---

Shipment weight	515 kg
Cartboard flat-packs	10 layers
Wooden pallet	29 kg
Plywood pallet	40 kg
Dimensions	2270 x 1270 x 1370 mm
Possibility of stacking	2 pods

# The Best Quality Office Pods at a Budget-Friendly Price



**Jetson** | **MUTE.**

 [insta.mute](#)  [mute-design](#) [hello@mute.design](mailto:hello@mute.design) [www.mute.design](http://www.mute.design)

[www.project-inrichting.nl](http://www.project-inrichting.nl)

[info@witteveen.nl](mailto:info@witteveen.nl)

[www.telefooncel.info](http://www.telefooncel.info)